

## TECHNICAL DATA SHEET – CUTTING FILAMENT

### BODYKNIFE2

BODYKNIFE2 can cut thick car body protection films as well as PET solar protection films, from simple to very complex shapes and contours.

Cutting tool composed of a thin metallic filament coupled together with an adhesive-coated white plastic film.

#### **PRODUCT FEATURES:**

##### Average values

- Width (mm): 4

#### **USER'S INSTRUCTIONS:**

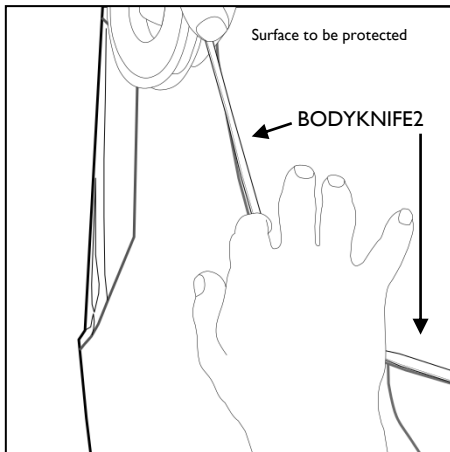

- Lay the BODYKNIFE2 on the clean and dry substrate surface in order to describe the path you want to cut (by carrying out the desired shape).

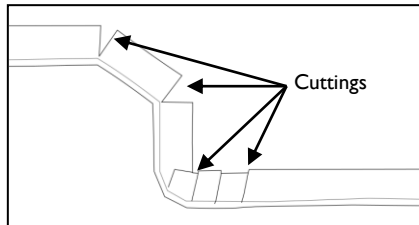

- Carry out cuttings in the BODYKNIFE2 film if too strong angles must be performed during application.
- Firmly apply the BODYKNIFE2 to the substrate.

*Make sure you keep an overlap of around 15 cm (5.91 in.) beyond the edge of the surface to be covered in order to easily grip the filament.*

- Cut the BODYKNIFE2 using scissors or a cutter.

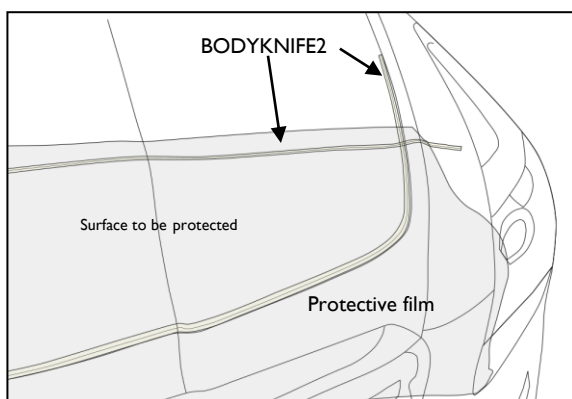

- Apply the protection film to the substrate, following the adequate installation method (please refer to the documentation specific to the applied films), leaving an additional material overhang beyond the cutting filament, and making sure to prevent covering the filament segment that serves for gripping.

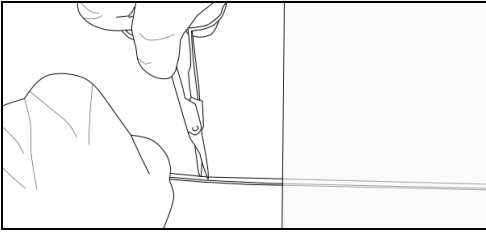

- Using scissors or a cutter, carry out the cutting of the white BODYKNIFE2 film about 10 cm (3.94 in.) from the edge of the protective film to be cut.

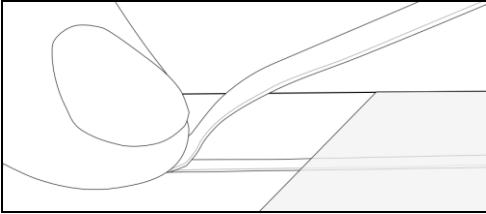

- Fold back the BODYKNIFE2 piece.
- Put a finger on the fold.
- Sharply pull on the free end to release the cutting filament.

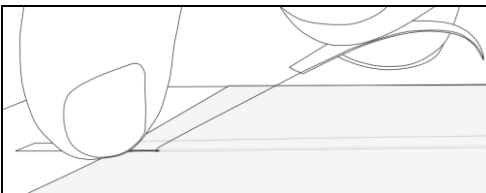

- Pull the metallic thread to the edge of the protective film to be cut.
- Put the finger on the edge of the protective film to be cut in order to carry out a precise cut.
- Sharply pull on the filament to start cutting. Then, carefully and continuously, pull on it until completion of the film cutting.

- Remove the excess car body protection film + residual tapes of the BODYKNIFE2 right after cutting while generously moistening the performed cutting.
- To finish, firmly squeegee the protection film edges.
- **Handle with care: risk of serious injury if BODYKNIFE2 is wrapped around the finger or hand when starting the cutting procedure, and during cutting as well.**

## **STOCKAGE**

- Shelf life (before application):  
The shelf life of this film is 2 years when stored unopened in its original packaging at a temperature of 21 °C (+70 °F) with relative humidity of 50 %.

### **NOTES:**

Due to the great variety of substrates and the growing number of new applications, the installer must check the suitability of the media for each application. All the published information is based on measurements regularly performed in the laboratory. It does not however constitute a binding guarantee. The seller cannot be held liable for indirectly related damages and assumes no liability for claims that are higher than the replacement value of the purchased product. All specifications are subject to potential changes without prior notice. Our specifications are automatically updated on our website [www.hexis-graphics.com](http://www.hexis-graphics.com).