



ROLLFIRST

PRODUCT SHEET



ADVANTAGES OF THE ROLLFIRST

- Reliable, simple and lightweight.
- Quick and easy to assemble.
- Sold with transport bag: provides protection and easy transport.



HEXIS PRODUCTS RECOMMENDED FOR GRAPHIC

- JT300M1
- POPPRIMO
- POP190ECOS
- FRONT5M1
- POP200ECOS



DIMENSIONS OF THE PRINTED GRAPHIC

- Width: 85 cm/34.5 in.
- Height: 220 cm/87 in of which 20 cm/8 in are in the casing.



Dimensions of the casing without feet:
91x86x865 mm*
 Dimensions assembled with feet:
2090x280x865 mm*

Dimensions of the transport bag:
115x115x900 mm*

*Height x depth x width



Weight (excluding graphic): 2 kg



ASSEMBLY

ROLLFIRST

1



The ROLLFIRST consists of a steel casing, a non-telescopic pole and a hanger.

2



Open the hanger.

3



Clip the top of the graphic in the hanger.

4

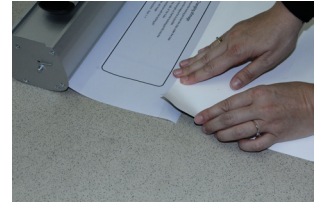

Partly expose the double-sided tape and start applying the bottom end of the graphic.

5

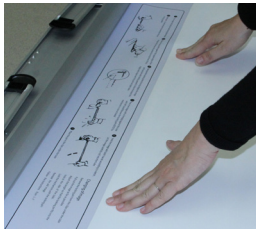

Continue applying the graphic until the full width is taped.

6

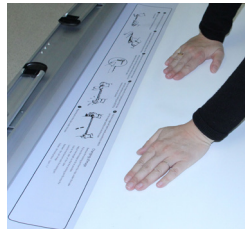

Once the graphic is applied to the tape, firmly press down over the full width to ensure proper adhesion.

7



Remove the pin to pull the graphic into the casing. Be careful to hold the graphic and let it roll up smoothly.

8

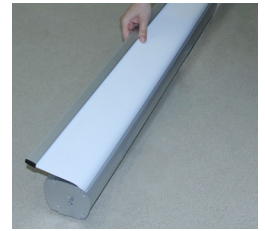

Roll the entire graphic into the casing.

9



Fit the pole into the casing.

10



Pull the graphic out of the casing while holding the pole.

11



Completely unroll the graphic and fix it to the pole.

12

