

ROLLDOUBLE

Product sheet

ROLLDOUBLE BENEFITS:

- › Double-sided roll-up banner: displaying 2 back-to-back graphics simultaneously.
- › Reliability, simplicity and lightweight.
- › Quick and easy assembly.
- › Sold with a carrying bag: protection and ease of transportation.



HEXIS PRODUCTS RECOMMENDED FOR PRINTING:

- › JT300M1
- › POPPRIMO
- › POP190ECOS
- › FRONT5M1
- › POP200ECOS

GRAPHICS DIMENSIONS FOR PRINTING:

- › Width: 85 cm.
- › Height: 220 cm of which 20 cm are inserted into the base.



 <p>Base dimensions without feet: 160x 95 x 865 mm</p> <p>Dimensions when assembled with feet: 2110 x 380 x 865 mm</p>	 <p>Transport bag dimensions: 185 x 125 x 900 mm</p>
Height x depth x width	
Weight (excluding graphics): 4.75 kg	

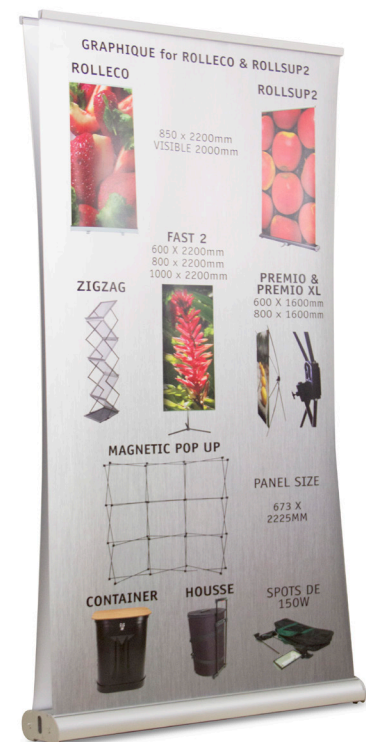

ROLLDOUBLE Assembly

1



ROLLDOUBLE is composed of a steel base, a non-telescopic mast and a hanger.

2

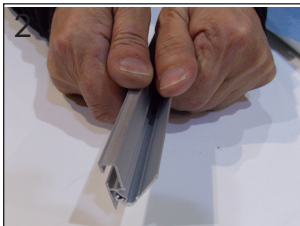

Open the header bar.

3

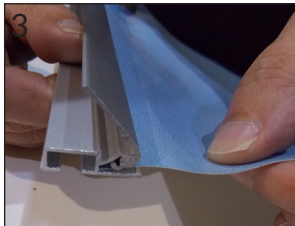

Insert and clip the top of the graphic into the header bar.

4



Remove a part of the double-sided adhesive tape and start applying the bottom of the graphic.

5

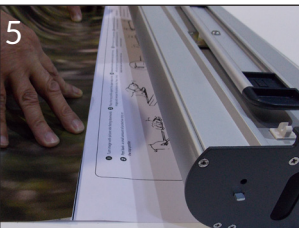

Keep applying the graphic until it is fully bonded.

6

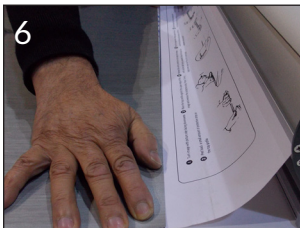

Once the graphic is stuck, press firmly to fix it definitively.

7

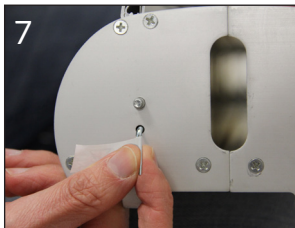

Remove the pin in order to slide the graphic into the base. Be careful to maintain the graphic and the base so that the winding is done properly.

8



Completely wind the graphic into the base, then repeat the work steps 2 to 8 to mount the second graphic.

9



Install the mast into the base.

10



Remove the graphic from the base while holding the mast.

11



Unroll the graphic until the top and attach it to the mast.

12



Repeat steps 10 to 11 for the second graphic.